

**Town of Bethel
Selectboard Meeting
Town Hall @ 6:30 pm
Monday, January 24, 2022**

[Zoom Link](#) Meeting ID: 882 3584 2663 Passcode: 651407 Call in: 1-646-558-8656

[When participating in person or via Zoom, please raise your hand or use the hand raised option (Zoom), so the Chair may call on you in an orderly manner.]

6:30 pm – Call the meeting to order and approve agenda.

Appointments

Public Comment*

Approval of the Warning for the March 1, 2022 Town Meeting

Motion to approve

Finalization of survey for Town Report

Discussion of Deputy Health Officer vacancy

Motion to appoint – if we have an interested party

Annual Certificate of Highway Mileage

Motion to approve

Saturday, February 12, 2022 Valentine Bonfire/Winterfest

Motion to approve event

Discussion of overhead doors for Town Garage

Motion to approve up to \$25,000 from Capital Improvement Fund

Discussion of Unemployment Insurance

Approval due by 2/11/22

Minutes and Communications:

1. Town Manager's Report
2. Selectboard Minutes from 1/10/2022
3. Other Communications –see packet
4. Any Other Business Necessary to Come Before the Board

* Public comment will be limited to items not already listed on the agenda, and to 3 to 5 minutes per person.

Town Manager's Report for January 24, 2022 meeting:

- Reminder, this meeting has a scheduled start time of 6:30 pm and will be 100% on Zoom.
- You must finalize and sign the March 2022 Warning. You will all have to come to the office on 1/25 to sign it. Monday will be the day you must decide whether to hold the meeting in person or move to Australian ballot for this Town Meeting. If you go to Australian ballot, you will make a motion to do so, also stating ballots will be mailed to registered voters upon request.
- I have taken all comments received and put them in this draft of the survey for Town Report. It can only be 1 page long, as it needs to fit on the back cover. We can add Gene's additional questions to the online form, if a majority of the Board agrees to do so.
- The Deputy Health Officer position is currently vacant, as Chris resigned, yet his information is still on the State's website.
- Nothing has changed on the annual highway mileage report.
- The Better Connections Steering Committee would like to hold an event on 2/12/2022 at the Recreation Area. Gene has additional information to share. I have spoken with the Fire Warden and Fire Chief. The Fire Warden, Geary Coogler, will be able to issue a permit, but needs Board approval first. The Fire Chief said the BFD will be unable to attend from 1 to 5 pm as requested, but will be aware of the event, and will of course respond if 911 is called. I have asked for clarification on the size of the fire and think you need to give specific dimensions as this may well be a large campfire, not a bonfire. I encourage you all to drive to the Recreation Area and look at trees, power line, location of abutting property, etc. so you have an understanding of the property. The fire has been planned for the parking lot, so damage is not done to the grass.
- I would like permission to spend capital fund money on replacing the overhead doors at the Town Garage. I am still waiting for one more bid.
- Dietre worked with VLCT PACIF, our insurance company, to get us a price on unemployment insurance. This is not an insurance we currently carry. If an employee collects unemployment, we are a reimbursable employer, meaning we pay the State back for an employee claim. The cost of the insurance would be split between departments. I did not include this in next year's budget, but feel we could cover the premium in the allotted salary/insurance sections of the proposed budgets.

**WARNING
TOWN OF BETHEL ANNUAL TOWN MEETING**

The legal voters of the Town of Bethel are hereby warned, and notified, to meet at the **WHITE RIVER UNIFIED MIDDLE SCHOOL, BETHEL CAMPUS GYMNASIUM**, in said Bethel on Tuesday, March 1, 2022, for voting by Australian ballot between the hours of 8:00 am and 7:00 pm for the election of officers and voting on those articles so noted.

1. To elect a Town Moderator for the term of one year.
2. To elect a Town Clerk for the term of one year.
3. To elect a Town Treasurer for the term of one year.
4. To elect by ballot, a Selectboard Member for a term of three years to succeed David Eddy, whose term expires.
5. To elect by ballot, a Selectboard Member for a term of two years to succeed Lindley Brainard, whose term expires.
6. To elect by ballot, a Lister for a term of three years to succeed Maurice Brigham, whose term expires.
7. To elect a Trustee of Public Funds under section 24 V.S.A. for a term of three years to succeed Eric Benson, whose term expires.
8. Shall the voters authorize total fund expenditures for operating expenses of \$2,418,146 of which \$1,983,678 shall be raised by taxes and \$434,468 non-tax revenues?
9. Shall the voters appropriate a total of \$26,200 to the following social service agencies, pursuant to 24 V.S.A. § 2691? (See the Town Report for a detailed description of each agency.)
10. Shall the voters appropriate up to the sum of \$127,080 to the White River Valley Ambulance, Inc., for continued service to Bethel residents?
11. Shall the voters authorize payment of real and personal property taxes in four (4) equal installments, with the due dates being August 15, 2022, November 15, 2022, February 15, 2023, and May 15, 2023, by delivery to the town office postmarked on or before that date?

Dated at Bethel, Vermont, this 24th day of January, 2022.

By the Selectboard members of the Town of Bethel:

Christopher Jarvis

Lindley Brainard

D. Gene Kraus

David Eddy

Paul Vallee

1-14-22
Version

Town of Bethel Survey

This voluntary survey was put together by the Selectboard to gather input from Bethel residents on various topics. We hope you will take the time to complete it.

1.) Should the Town take the following measures to promote more affordable housing and increase the grand list (resulting in lower property taxes)? (Check all that apply):

- allow greater density in certain areas by reducing lot area minimum sizes?
- provide density bonuses for projects that provide some units for low-income housing?
- allow multi-family housing in all zoning districts?

2.) Due to the challenges of hiring/retaining a part-time Constable, and the increase in time they need to process paperwork, engage with community members, court appearances, etc., would you support expanding the Constable hours and compensation to full-time? (Constable responsibilities include working with the Town and school community, animal control, speed enforcement, assisting the State Police, assisting with domestic issues, enforcement of drug and other laws.)

yes no

Comment: _____

**** There are additional questions regarding policing in the online version of this survey. ****

3.) Would you like to vote on authorizing cannabis retailers in town pursuant to 7 V.S.A. § 863 at the March 2023 Town Meeting? ("Cannabis retailer" means a person licensed by the state Cannabis Control Board to sell cannabis and cannabis products to adults 21 years of age and older for off-site consumption.)

yes no

4.) Would you like to continue to vote at Town Meeting via a **floor vote** (where residents gather at the school and vote by voice), or move to **Australian ballot** (the practice of voting at designated polling places during designated polling hours (usually, 7 a.m.–7 p.m.)? With Australian ballot, ballots would be available 20 days prior to Town Meeting for absentee/early voting.

Floor Vote **Australian Ballot**

IF you would like to change to Australian Ballot, which of the warned articles would you like to see available for voting? (Check all that apply)

- Annual Election of Town Officers (Selectboard, Town Clerk, etc.)**
- Annual Municipal Budget**

5.) Bethel was awarded a Better Connection grant to create a village accessibility plan that will help ensure our community is accessible, connected, vibrant and welcoming for all. If we could change one thing to make Bethel village more accessible to you, what would it be?

Comment: _____

(To learn more about Bethel For All and provide additional input, please visit www.bethelforall.org.)

Please mail or drop off your survey to the Town Office at 134 South Main Street, Bethel, VT 05032, email it to betheltownoffice@comcast.net or go to www.townofbethelvt.com to complete online.

We could add these questions to the online survey.

From: [D. Gene Kraus](#)
To: [Therese Kirby](#)
Subject: Possible question 2
Date: Monday, January 10, 2022 9:55:39 PM

I know it's long, but it may fit the bill. Part A addresses Dave's concern. Part B addresses Lennie's concern in part. Part C is a satisfaction question, Part D address the budget question.

2. The town of Bethel is currently provides limited police services. In Vermont a Constable is only authorized to perform limited police services. Finding qualified individuals willing to serve part-time is becoming increasingly difficult. With this in mind ...

A. What police services would you like the town to provide? (Check all that apply)

- Traffic control issues like speeding, DUI, etc.
- Animal protection from abuse, lost pets, dealing with diseased animals, etc.
- Domestic violence
- Homeless persons
- Vagrants, public drunkenness or other individuals creating a public disturbance
- Enforcement of Drug laws
- Crime
- Other (Please specify _____)

B. What services do you think would be better served by trained qualified social service personnel? (Check all that apply)

- Animal protection from abuse, lost pets, dealing with diseased animals, etc.
- Domestic violence
- Homeless persons
- Vagrants, public drunkenness or other individuals creating a public disturbance
- Other (Please specify _____)

C. Which of the following statements reflects your personal views? (Select one)

- The level of polices town currently provides exceeds our needs.
- The level of polices town currently provides meets our needs.
- The level of polices town currently provides does not meet our needs.

D. If it were necessary to increase the services, or if it became necessary to attract qualified candidates, are you willing to have the town budget for the services you checked above? (Pick One)

- Yes for police services if this would not raise taxes.
- Yes for police services, even if doing so requires an increase in taxes.
- Yes for social services if this would not raise taxes.
- Yes for social services, even if doing so requires an increase in taxes.
- No for police services
- No for social services
- No for either police or social services.

Please add any additional comments you would like to share.



District 4
Certcode 1404-0

**CERTIFICATE OF HIGHWAY MILEAGE
YEAR ENDING FEBRUARY 10, 2022**

Fill out form, make and file a copy with the Town Clerk, and submit the Mileage Certificate on or before February 20, 2022 to: Vermont Agency of Transportation, Division of Policy, Planning and Intermodal Development, Mapping Section via email to: aot.mileagecertificates@vermont.gov or if necessary via mail to: VTrans PPAID - Mapping Section, 219 North Main Street, Barre VT 05641.

We, the members of the legislative body of **BETHEL** in **WINDSOR** County on an oath state that the mileage of highways, according to Vermont Statutes Annotated, Title 19, Section 305, added 1985, is as follows:

PART I - CHANGES TOTALS - Please fill in and calculate totals.

<i>Town Highways</i>	<i>Previous Mileage</i>	<i>Added Mileage</i>	<i>Subtracted Mileage</i>	<i>Total</i>	<i>Scenic Highways</i>
<i>Class 1</i>	0.892				0.000
<i>Class 2</i>	11.940				0.000
<i>Class 3</i>	56.22				0.000
<i>State Highway</i>	14.286				0.000
Total	83.338				0.000
* <i>Class 1 Lane</i>	0.000				
* <i>Class 4</i>	35.00				0.000
* <i>Legal Trail</i>	0.00				

* Mileage for Class 1 Lane, Class 4, and Legal Trail classifications are NOT included in total.

PART II - INFORMATION AND DESCRIPTION OF CHANGES SHOWN ABOVE.

1. **NEW HIGHWAYS:** Please attach Selectmen's "Certificate of Completion and Opening".

2. **DISCONTINUED:** Please attach SIGNED copy of proceedings (minutes of meeting).

3. **RECLASSIFIED/REMEASURED:** Please attach SIGNED copy of proceedings (minutes of meeting).

4. **SCENIC HIGHWAYS:** Please attach a copy of order designating/discontinuing Scenic Highways.

IF THERE ARE NO CHANGES IN MILEAGE: Place an X in the box and sign below.

PART III - SIGNATURES - PLEASE SIGN.

Signatures of Selectmen/ Aldermen/ Trustees:

Signature of T/C/V Clerk: _____ Date Filed: _____

Please sign ORIGINAL and return it for Transportation signature.

AGENCY OF TRANSPORTATION APPROVAL: Signed copy will be returned to T/C/V Clerk.

APPROVED:

Representative, Agency of Transportation

DATE:

Department of Health

Environmental Health
108 Cherry Street – PO Box 70
Burlington, VT 05402-0070

HealthVermont.gov

[phone] 802-863-7220
[fax] 802-863-7483
[toll free] 800-439-8550

Agency of Human Services

December 1, 2021

Chair of the Selectboard
Town of Bethel
Town Clerk's Office
PO BOX 404
Bethel, VT 05032



Dear Sir or Madam:

I am writing to you regarding your Deputy Health Officer's term of office, which, will expire on 1/31/2022. We would like to have a recommendation from the Selectboard for a Deputy Health Officer to serve for the next three years. The law provides that the Department of Health appoint a Health Officer upon recommendation of the Selectboard. Thus, we urge you to give this matter your immediate attention.

The Department of Health believes that you should recommend someone who is interested in responding to and resolving **issues associated with rental housing, water/septic, mold and other public health issues** that often arise or are disputed between different parties.

Electronically fillable versions of the Town Health Officer Recommendation and Oath Forms can be found on the Vermont Department of Health's Town Health Officer webpage (healthvermont.gov/tho), or you may use the enclosed forms.

If you designate a new individual to be appointed to this position, please ensure that the recommended individual takes the enclosed oath/affirmation in the presence of a person authorized to administer oaths/affirmations. This must be returned to the Health Department in tandem with the recommendation form. We will be unable to process the appointment of the new Health Officer until we are in possession of the completed oath.

If you have any questions please contact me at 800-439-8550.

Sincerely,

Meg McCarthy
Compliance and Enforcement Advisor
Environmental Health Division
Vermont Department of Health

Enclosures (2)





FOR OFFICE USE ONLY

Beginning Date: _____
Expiration Date: _____
Resignation Date: _____
Entered: _____

Deputy Town Health Officer Recommendation Form

This is a: New Appointment Re-appointment

Is a resignation letter needed from previous Health Officer? Yes No

Start Date: _____ Town/Municipality: _____

County: _____ Full Name: _____

Home Delivery Address: _____
(DO NOT USE the Town Clerk Office or a Business for your Home Address)

Street Address for UPS Deliveries: _____

Email Address: _____

Telephone(s): W: _____ H: _____ Cell: _____

Education: High School ___ College ___ Other (list) _____

Professional Degree: ___ (e.g. MD, RN, DVM, DDS) Occupation: _____

Please give a brief statement noting why the select board believes the recommended individual will make a good Health Officer:

Signed: _____
Chair of the Local Board of Health Board Meeting Date

Print Name: _____

Return completed recommendation form to:
VT Department of Health / Environmental Health
108 Cherry Street • PO Box 70
Burlington, VT 05402



Town Health Officer Oath / Affirmation

In taking actions as a Local Health Officer under the authority of 18 VSA Chapters 3 and 11, I do solemnly swear/affirm that I will be true and faithful to the State of Vermont, and that I will not, directly or indirectly, do any act or thing injurious to the Constitution or Government thereof, so help me God (oath)/under the pains and penalties of perjury (affirmation).

I do solemnly swear/affirm that I will faithfully execute the office of Local Health Officer for the municipality named below and therein do equal right and justice to all persons, to the best of my judgment and ability, according to law, so help me God (oath)/under the pains of penalties of perjury (affirmation).

(Signature)

(Name Printed)

Local Health Officer for the Municipality of

Date

From Vermont Department of Health's website

Town Serving:

Bethel

Title:

Town Health Officer

Name:

Neal Fox

Home Phone:

802-234-9542

Fax Number:

802-234-6840

Email:

neatric1@myfairpoint.net

Termination Date:

3/31/2023

Town Serving:

Bethel

Title:

Deputy Health Officer

Name:

Christopher Jarvis

Cell Number:

802-839-0046

Fax Number:

802-234-6840

Email:

cjarvis@pikeindustries.com

Termination Date:

1/31/2022

WE  **BETHEL**
FOR
ALL

Outdoor Activities



Saturday
Feb 12
1-5 pm
Bethel
Recreation
Center

Bonfire Snacks



VALENTINE
BONFIRE
WINTERFEST

[WWW.Bethel Bonfire.org](http://WWW.BethelBonfire.org)

591

THERMACORE[®] **DOOR SYSTEMS**



INSULATED SECTIONAL DOORS



**THE BEST SELLING SYSTEM
IN THE THERMACORE[®] LINE.
EXCEPTIONAL THERMAL EFFICIENCY
FOR EXTREME CLIMATIC CONDITIONS.**



**INDUSTRY LEADING
COMMERCIAL & INDUSTRIAL SOLUTIONS**



Cover image:
Double Thermal Acrylic lites, White paint finish

Image above:
Aluminum Sash Section with DSB glazing lites, Tan paint finish

Standard features at a glance

Thermal efficiency

R-value*	14.86 (2.63 K m ² /W)
U-value	.07 (.380 W/K m ²)
Thermal break	PVC
Air infiltration	at 15 mph (24 kmph): .08 cfm/ft ² (1.46 m ³ /hr/m ²) at 25 mph (40 kmph): .08 cfm/ft ² (1.46 m ³ /hr/m ²)

Construction

Panel thickness	1 5/8" (41 mm)
Max height	24'1" (7341 mm)
Max width	35'2" (10719 mm)
Exterior steel	.015" (.38 mm) galv.
Exterior surface	Ribbed, textured
Standard springs	10,000 cycle

Color options

Interior colors	White
Exterior colors	White, Tan, Gray, Industrial Brown,

Limited warranty

10-year delamination
1-year door
3-year/20,000 cycle door and operator system (material and workmanship)

Options

- Glazing: Insulated glass, tempered glass, polycarbonate, multi-wall polycarbonate, etc.
- Thermal glazing
- Aluminum sash section available to 24'2" (7366 mm) wide
- Four-section pass door
- High-usage components
- High Performance fluoropolymer coating - (Trinar® or equivalent); Kynar White, Brown, Beige
- Knock & Lock® Breakaway Door System
- Wind load options
- Electric operator
- Chain hoist
- Posi-Tension™ drums
- Safety bottom fixtures
- Bottom-sensing edge
- Flexible jamb, header seal
- Exhaust ports

*R-value: R-value is a measure of thermal efficiency. The higher the R-value the greater the insulating properties of the door. Overhead Door Corporation uses a calculated door section R-value for our insulated doors.



The most thermally efficient door system

This 1 5/8" (41 mm) thick, steel-polyurethane-steel panel construction, heavy-duty door fits a wide range of opening sizes and the spectrum of applications — making it the best-selling door system in the Thermacore® line and one of the most-specified insulated sectional doors in the industry. Boasting an R-value of 14.86 (2.63 K m²/W), a U-value of .07 (.380 W/K m²), and one of the best air infiltration ratings, the Thermacore® 591 will meet or exceed almost any thermally efficient application requirement.



Double Thermal Acrylic windows, White paint finish

Panel options

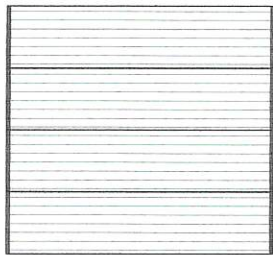

Ribbed, textured panel

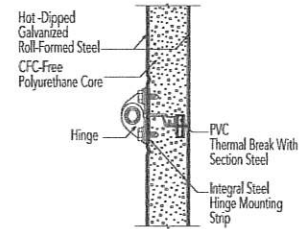
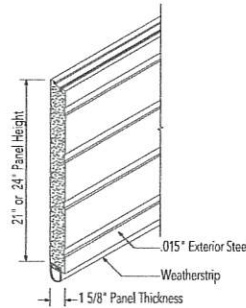

Color options



White



Industrial Brown



Gray

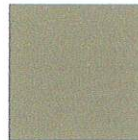

Tan

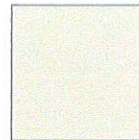

Trinar White

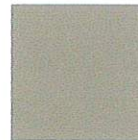

Trinar Beige



Trinar Brown

Actual colors may vary slightly from these shown due to fluctuations in staining or the printing process. Ask your Overhead Door Distributor for color samples.

Glazing options



Double Thermal Acrylic (25" w by 12" h)



Aluminum Sash Section* with DSB glazing

*Standard color White



Insulated DSB (24" w by 7" h)

The Genuine. The Original.



Date: 1/4/2022 4:04 PM

Exterior View

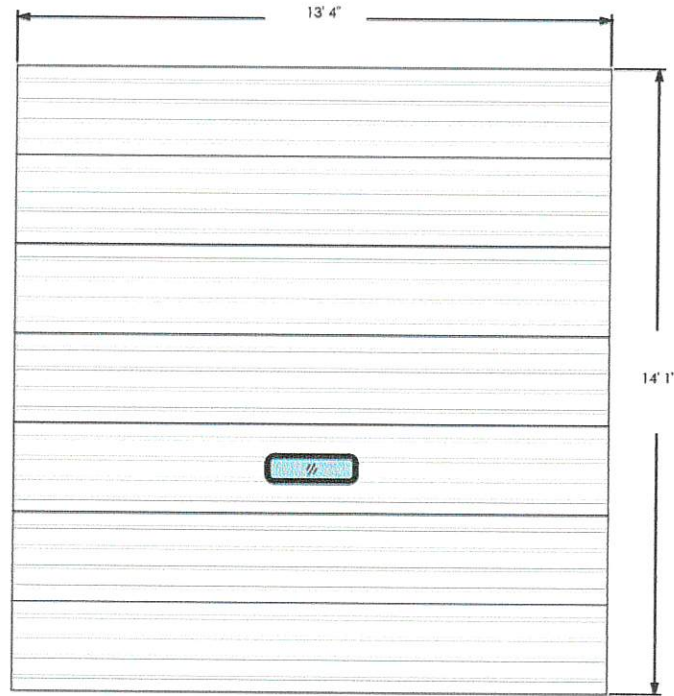

Model: 591 - Thermacore Heavy Duty 1-5/8"

Design: Ribbed Panel

Door Width & Height (Ft): 13'4" x 14'1"

Window Style: 24" x 7" Clear DSB Insulated

Options:



BETHEL TOWN PROPOSAL FOR VERB TRUST UI PROGRAM MEMBERSHIP

To: Therese Kirby, Town Manager, Bethel
From: Kelley Avery, Senior Benefit Programs Administrator
Date: January 13, 2022
RE: Estimated Costs for 2022 VERB Trust UI Program Participation

Therese, thank you for your interest in the Unemployment Insurance (UI) Program. Based on the payroll figures provided (see page 2) and also claims data submitted, we propose a rate of .90%. This is slightly lower than our pool's current average rate of 1.14%. Using this proposed rate, below is the projected cost for 2022 membership for the Town of Bethel.

Table with 2 columns: Description and Amount. Rows include 2022 Estimated Taxable Wages (\$212,080), x 2022 Proposed Rate (.90%) (\$1,909), (April - Dec Costs) (\$1,432), + 2022 Management Fee (\$100) (\$1,532), and Total Cost April - Dec 2022 (inc mgmt fee) (\$1,532).

Handwritten calculations: BLTS = 22.5% 344.70, Muni = 19.15% 293.37, BFD = 4.36% 97.43, Constable = 4% 61.28, Pool = 5.19% 79.51, PN = 26.03% 398.77, 8.73% 133.74. Includes note 'Sawyer/White'.

The VERB Trust UI Program provides our members protection adequate to match the level of annual taxable payroll exposure. In your group's case, we have quoted you based on your most recent payroll year, 2021, and have applied the current state taxable wage base (TWB) of \$15,500. In addition, we have derived your rate based on your best four out of the last five years of claims experience. Although we can guarantee you a continued rate of .90% for 2022, we cannot guarantee any estimate as yet on 2023 costs as the state will not determine the TWB for next year until October.

The UI Program provides our members a level of stability due to the power of pooling, thus spreading the claims risk across the membership. Participation in the UI Program entitles you to such benefits as legal counsel for unemployment hearings, unemployment claims administration via our third party administrator, TALX/Equifax, quarterly claims report detail, member education regarding legislative changes and direct payment to the state of all your unemployment claims. Once you have been a member of the program for at least a full calendar year, you may also be eligible for contribution credits at renewal depending on pool performance and the Trust net position.

If you require additional information or have questions, please feel free to call me at 800-649-7915, ext. 1965 and I will be happy to discuss this information in more detail. Please note, a decision will be required by February 11th for an April 1st effective date.

Thank you! (with an upward arrow pointing to the date in the previous paragraph)

Town of Bethel
Selectboard Meeting
Via Zoom @ 6:30 pm
Monday, January 10, 2022

Zoom Link Meeting ID: 841 5484 2402 Passcode: 606177 Call in: 1-646-558-8656

Present: All via Zoom: Lindley Brainard, Dave Eddy, Chris Jarvis, Gene Kraus, Paul Vallee, Therese Kirby, Julie Kraus and recorded by Orca Media. Visitors: Doug Marshall, Leonard Meek, Jesse Plotsky, Jessica & Jashua Tetrault, Laura Perez, and Keith Bollman

6:30 pm – Call the meeting to order and approve agenda.

Chris Jarvis called the meeting to order. Gene Kraus moved, Paul Vallee seconded, to approve the agenda.

Appointments

6:30pm - Sadie, Jessica & Jashua Tetrault: re: 48 Dartt Hill Road culvert

Chris Jarvis reported on the research done for this issue. Therese Kirby reported that Towns are immune from tort claims, as we have a “privilege defense”. The culvert has been in place over 15 years, giving us a prescriptive easement, leaving the Town only responsible for keeping the culvert in working order. She recommended the Road Crew try and create a ditch along the bank toward the river, and install some stone at the culvert outflow to help slow down the flow of water and possibly redirect it toward the river. She also suggested the Road Crew take the grader and remove any berm on the river side of Dartt Hill, which would allow water on the road to sheet off before the culvert. She has reached out to GMP regarding any damage to their pole, and they said their pole is fine. The Town could provide the Tetrault’s one 15’ x 20’ section culvert when they build their new house, but they would need to sign a release for any potential claims against the Town. Chris Jarvis asked the Selectboard to allow Tetrault’s a few days to review the remedy and get in touch with Therese. Therese Kirby will look into zoning regulations that may apply to developing the property and let Jessica and Jashua know.

6:45 pm - Equity & Inclusion Committee re: their 11/15/2021 letter to the Selectboard.

We received a letter dated 11/15/2021 from the Bethel Equity and Inclusion Committee (EIC) in response to budget discussion at the 10/25/2021 Selectboard meeting, in particular the proposal for increased hours in the constable position. Chris Jarvis said Bethel had been fortunate to hire a constable jointly with Rochester and Hancock, but when that Constable moved on, Bethel hired Oscar Gardner for 20 hours a week. This was before he took a full-time position in Royalton. Now we get a smaller number of hours.

Laura Perez noted the Committee has reviewed the constable’s report, and there were some issues with the data. Therese Kirby asked Laura Perez to let her know what the issues were so she could address them with Oscar Gardner, as he is the one who wrote the software he uses. Chris Jarvis reported a new speed cart has been budgeted for, as well as two more flashing solar speed signs. The EIC continues to be concerned about speeding, equity and animals. Referring to Page 2 of EIC’s letter, the Committee acknowledges they

do not have a complete solution on this problem. What they are looking for is evidence of activity. As there has been no study done, the EIC requests the Town do a survey of residents about their needs. Gene Kraus would like the EIC to assist with the research. Therese Kirby stated she currently has no time to do it. The EIC also noted they have postponed their two Community Conversations on speeding for now. Regarding #6 on Page 2 of the EIC letter, Chris Jarvis reported the Town of Island Pond has put more police on the street to deal with these issues, and this has significantly reduced crime in their Town. Regarding homelessness, the officer is out there as a tool to help direct people to available resources. Leonard Meek said that Vermont Digger, on 1/7/2022, published an article that referenced a statewide report about blacks being arrested more often arrested. Therese Kirby will provide the article to the Selectboard.

The Selectboard needs to appoint an Alternative Authorized Representative for the \$107,900 Phase II engineering loan.

Motion made by Paul Vallee, seconded by Gene Kraus, to appoint Bethel Town Treasurer, Pamela Brown, as the Alternate Authorized Representative for data for the \$107,900 Phase II engineering loan. Motion passed.

Discussion of a Town of Bethel Meeting Survey

Gene Kraus shared an item to be on the Randolph Town Meeting agenda asking their Energy Committee be empowered to work with nearby towns and make proposals to reduce municipal energy costs, lower consumption of fossil fuels and enable seminars on weatherization and energy generation. Therese Kirby will give this information to the Bethel Energy Committee.

A survey has been drafted for inclusion in the Town Report and it needs Board suggestions/additions. The survey will be on the back cover of Town Report, so it can be torn off and returned or residents could follow a link to an online survey. If this year goes to Australian ballot, like we think it will due to an uptick in COVID, then the vote to go Australian ballot would be off removed from the warning. This is per S-172, the legislation just passed giving the Selectboard the authority to move to Australian ballot or move Town Meeting to another time. If that is the case, then Therese Kirby will be adding a question to the survey about Australian ballot.

Gene Kraus suggested the Selectboard has too much information regarding the constable question to put on the survey without sharing this information with the public so they can make an informed decision. Dave Eddy suggested using "police services" and define what these services would be. Chris Jarvis reminded the Board, that we are not changing to a full-time officer, just increasing the hours to make the position more attractive and to allow for the time it takes Officers to process tickets, make court appearances, etc. We asked EIC to help with research from the community, but that information is not available yet. The question is, should this item be taken off the survey. Chris Jarvis wants it on the survey, but agrees to changing the wording. Leonard Meek said the Selectboard knows why it is doing this, but the citizens do not. If hours are increased, that needs to be clarified for the citizens. It also states property taxes would increase. Lindley Brainard understood it was a budget issue and not a property tax issue. Paul Vallee wants to keep the question on the

survey, but we need to flesh it out more. Dave Eddy said few people are aware of the amount of paperwork required of a constable. Royalton Police Officer's walks the streets to be part of the community. Therese Kirby will rework the survey and redefine the constable question.

Bethel needs a new Deputy Health Officer, as the term will expire on 1/31/2022. Please speak with anyone you think would be interested in the position. Position details may be found on the State of Vermont, Department of Health website.

Discussion of Leave Time Personnel Policy

Four employees, for a host of reasons, did not take all vacation time they were entitled to from 2021. Our Personnel Policy allows the accumulation of up to twice their annual leave time. These employees would lose excess leave time. Gene Kraus wants to accept the Town Manager's recommendation recognizing this has been an extraordinary year. Dave Eddy prefers "use it or lose it." Noted it is not healthy to not use your vacation. Lindley Brainard recommends give them a year, maybe until January to use this vacation time. Chris Jarvis suggested allowing up to 40 hours to be rolled over and used by June 30. Motion made by Gene Kraus, seconded by Lindley Brainard, to allow 48 hour of vacation time over allotted accrual by employees to be carried over and used by December 31, 2022. Motion passed.

Minutes and Communications:

- Town Manager's Report
- Motion made by Paul Vallee, seconded by Dave Eddy, to approve the minutes of the 12/27/2021 Selectboard meeting. Passed with correction to the spelling of Paul Vallee's name.

At 8:20 pm Lindley Brainard moved, Paul Vallee seconded, to move into executive session to discuss confidential attorney-client communications and contract negotiations with the Town of Royalton due to the June 30, 2022 termination of the Interlocal Agreement per 1 V.S.A. § 313 (a) (1) and 313 (a) (1) (a). Motion Passed.

At 8:50 pm Lindley Brainard moved, Paul Vallee seconded, to exit Executive Session.

Due to COVID concerns, the Board decided unanimously to hold their 1/24/2022 meeting via Zoom.

At 8:52 pm Lindley Brainard moved, Paul Vallee seconded to adjourn. Motion passed.

Submitted by

Julie Kraus

Year in Review

FYI

In June of 2021, Governor Scott lifted Vermont's State of Emergency response to COVID. During 2021, eligible Bethel residents applied for and received, over \$22,800 in COVID relief money that was applied to their water/sewer accounts. This program was funded and sponsored by the State of Vermont.

We have included a new feature in Town Report, outlining grants we were awarded in the fiscal year. The chart includes the name of the granting agency, the amount of the grant and what it was used for. In 2021 we received over \$279,000 in grant money. We have recently applied for \$500,000 via the Vermont Outdoor Recreation Economic Collaborative (VOREC) grant program for trail building, trail markers/signs, benches, kiosks, mapping and economic assistance to local businesses, a \$58,000 scoping study grant from FEMA for a project on Gilead Road, a \$30,000 grant from VTRANS for stone line ditching and culvert replacement on Wright Road and a seven-town cooperative grant for zoning by-law updates.

To help reduce the damage to Town roads during rain storms and the spring thaw, property owners are reminded it is your responsibility to manage your own stormwater runoff. You should be keeping your driveway crowned, and your ditches and culverts clear of debris.

The Equipment Committee approved the purchase of the 2021 Chevy 6500 to replace the 2015 F550 (one ton) at the Town Garage. This purchase was part of the capital equipment plan for highway equipment. Due to the annual appropriation, we were able to purchase this truck without borrowing any money. We will keep the F550 for checking roads and other road maintenance.

During 2021, the Selectboard adopted a Social Media Policy, Highway Access Policy, Policy for the Placement of Political Campaign Signs, new rules for the Shooting Range (including registering with the Town Office), amended Zoning Bylaws, and an updated Hazard Mitigation Plan. We have also launched Zoom again, and now hold hybrid Selectboard meetings.

Bethel received \$291,602.34 from the American Rescue Plan Act. The money must be obligated by December 31, 2024. The Selectboard will be having discussions in 2022 around the eligible water/sewer infrastructure and other uses of the money. Other discussions for 2022 will be retail cannabis and housing density.

Bethel, like other communities, continues to struggle to find volunteers to fill committee vacancies and other appointed positions. Without volunteers, the Town's budget will need to grow, as we will be forced to hire staff to manage the workload. The Town currently needs a Tree Warden, and there are multiple vacancies on both the Planning Commission and Equity & Inclusion Committees. Please read the Town Committee Summaries in the Town Report, and check our website to read current meeting minutes, to see what issues committees are currently tackling. Most committees now host a hybrid or fully online Zoom meeting, making participation easier. Not interested in joining a committee? Other ways to volunteer include, shoveling the skating rink, joining the volunteer Fire Department or keeping flowerbeds weeded and watered.

On behalf of the Selectboard and the Town Manager, we hope you all have a safe and healthy 2022.

Selectboard:

Chris Jarvis - Chair, Lindley Brainard, Dave Eddy, D. Gene Kraus and Paul Vallee

Town Manager Therese Kirby

Town of Bethel, Vermont
Conservation Commission Meeting Minutes
Tuesday, December 14th, 2021
Town Offices, 134 South Main Street

Meeting brought to order at 6:30 PM.

Present: Ferron Griffin, Mary Floyd, Lisa Campbell, Mark Heckmann, Danny Dover, Chris Fors, Eric Webb

1. Minutes: Minutes from 11/9/21 were reviewed and accepted.

2. Climate Policy Update

A discussion of Gene Kraus' proposal to the select board and the SB action, the CC participation at that SB meeting, and the recent publication of the Climate Council Document took place.

3. VOREC Grant update

Ferron reported that Rebecca Sanborn had completed the grant application. Chris discussed related trails behind the recreation area and possible new trails behind the school and at Carla's Meadow, and trail easements with adjacent property owners. He mentioned Zack Freeman as a potential asset to assist in building multi-use trails.

4. Climate Forester Meeting Setup Date

Danny will continue to communicate with Ali Kosiba to arrange this date. Other community's CC members will be invited to this event when scheduled.

5. CC's property signs

Signs have been completed and received. It was suggested that one be placed at the entrance to Branliere Town Forest on Main Street near the Town Office, 2 at Carla's Meadow adjacent to Route 12, and another one at the Ball Field entrance to Carla's Meadow.

6. Town Report Write-up

Ferron will take this task over from Mary. He will include information about the trails at Carla's Meadow, the 2021 Forward Festival booth, and Quimby Town Forest boundaries. Mary will research CC members terms and get those to Kelly for the Town Report.

7. Other Business

Mary shared Planning Commission minutes for November. The CC will follow their discussion for changes and hopefully participate in some of their meetings. Mary has asked Eric Benson to forward their minutes to her and Danny.



FYI

State of Vermont
Agency of Transportation
219 North Main Street
Barre, Vermont 05641
vtrans.vermont.gov

Agency of Transportation

January 19, 2022

Dear Colleagues,

The Vermont Agency of Transportation will be posting new signs with weight limits for emergency vehicles on 39 bridges throughout the State this month. Under federal law, the Fixing America's Surface Transportation Act (FAST Act), and in response to a trend that trucks continue to get larger, with some exceeding the weight of trucks that were in use when many bridges were designed, the Federal Highway Administration (FHWA) is requiring States to expand their load ratings to include emergency vehicles and post if required. Load ratings determine the effect that these heavier and larger trucks have on a bridge, the bridge's capacity to safely handle the load, and whether a posting is needed.

Vermont is among many states working to meet this posting requirement. The goal is to ensure that emergency responders are aware of the potential safety concern as it relates to emergency vehicles. By January 30, 2022, all applicable bridges in the State highway system must have weight limits posted. By the end of 2022, load rating for all remaining bridges in Vermont must be completed and posted, if necessary, by January 30, 2023.

With the exception of one State bridge sign that will show only a gross weight to match existing posting, all signs on State bridges will show a maximum single axle, maximum tandem, and maximum gross weight in tons that should, based on calculation and being the only vehicle straddling centerline, cross the bridge:



Vermont statute allows exemptions for construction, maintenance, and emergency response vehicles (<https://legislature.vermont.gov/statutes/section/23/013/01399>). While fire apparatus and emergency response vehicles may choose to cross a bridge, the posting will identify the risk.

For additional information and a list of all bridges and their posted values, please go to the VTrans website at <https://vtrans.vermont.gov/emergency-vehicles>. If you have questions, please contact our Bridge Inspection Program Manager, Pam Thurber at Pam.Thurber@vermont.gov.

Sincerely,

DocuSigned by:
Joe Flynn
Joe Flynn

Transportation Secretary

